

ITEM NO.	PART NUMBER	Material	Thickness	QTY.
1	PA-2A1-DMX	5052-H32 Aluminum	0.0598 Inch	1

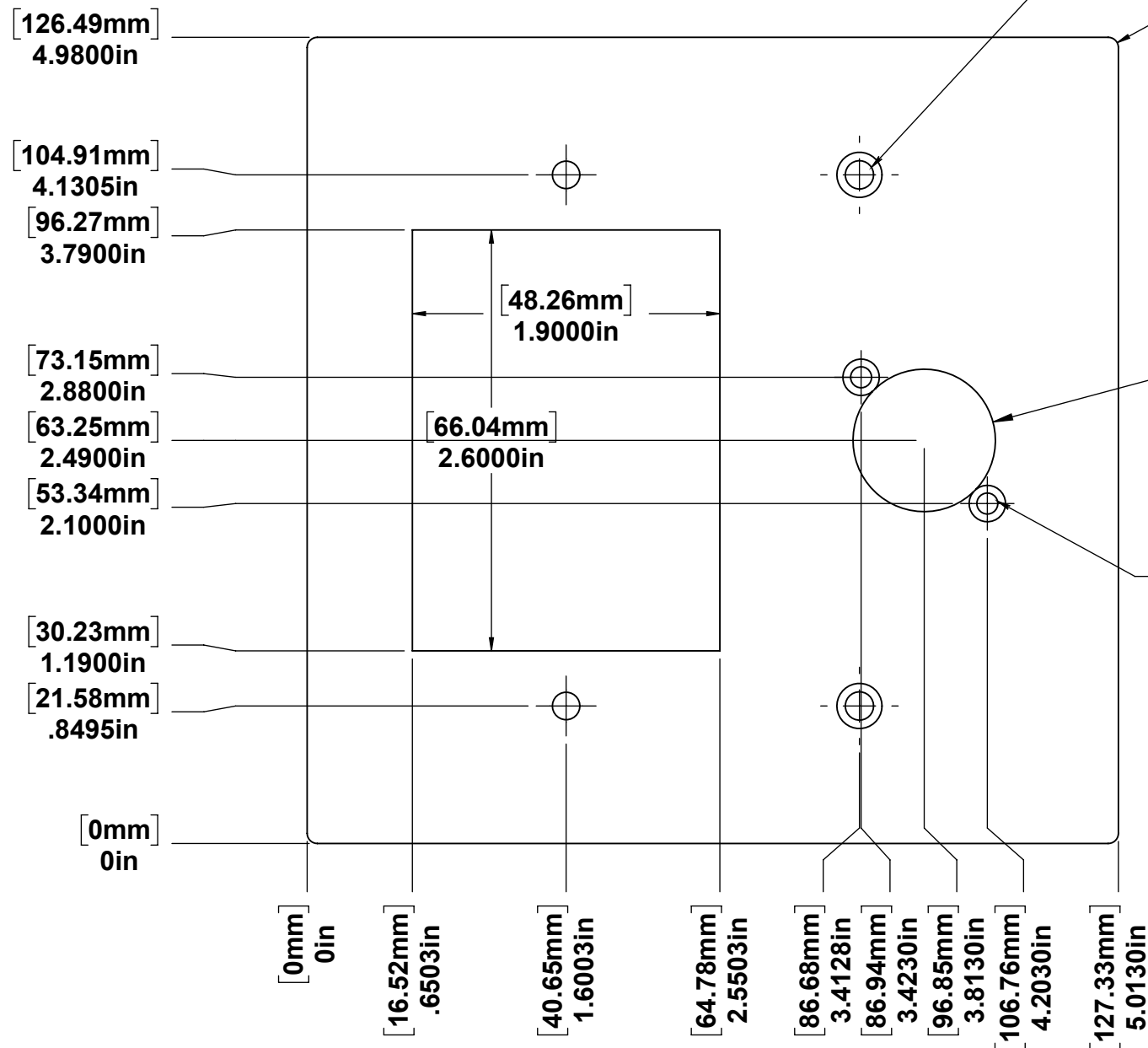
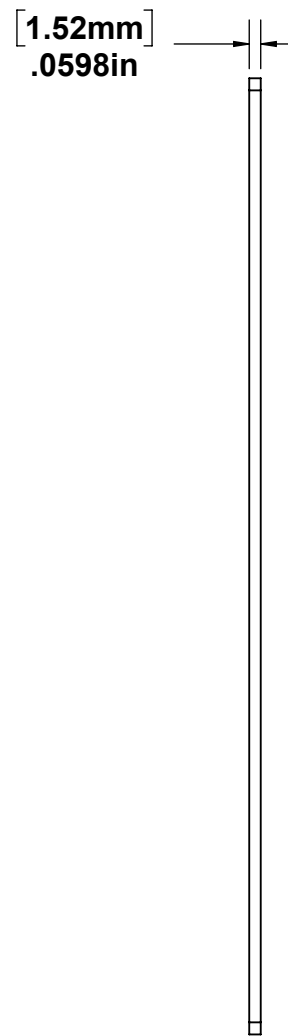

Countersink Typ x 2 for 6-32 Flat Head to sit flush or just below surface.

[1.60mm] R.0630in

<DIAM> [22.35mm] .8800in

Countersink Typ x 2 for 4-40 Flat Head to sit flush or just below surface.

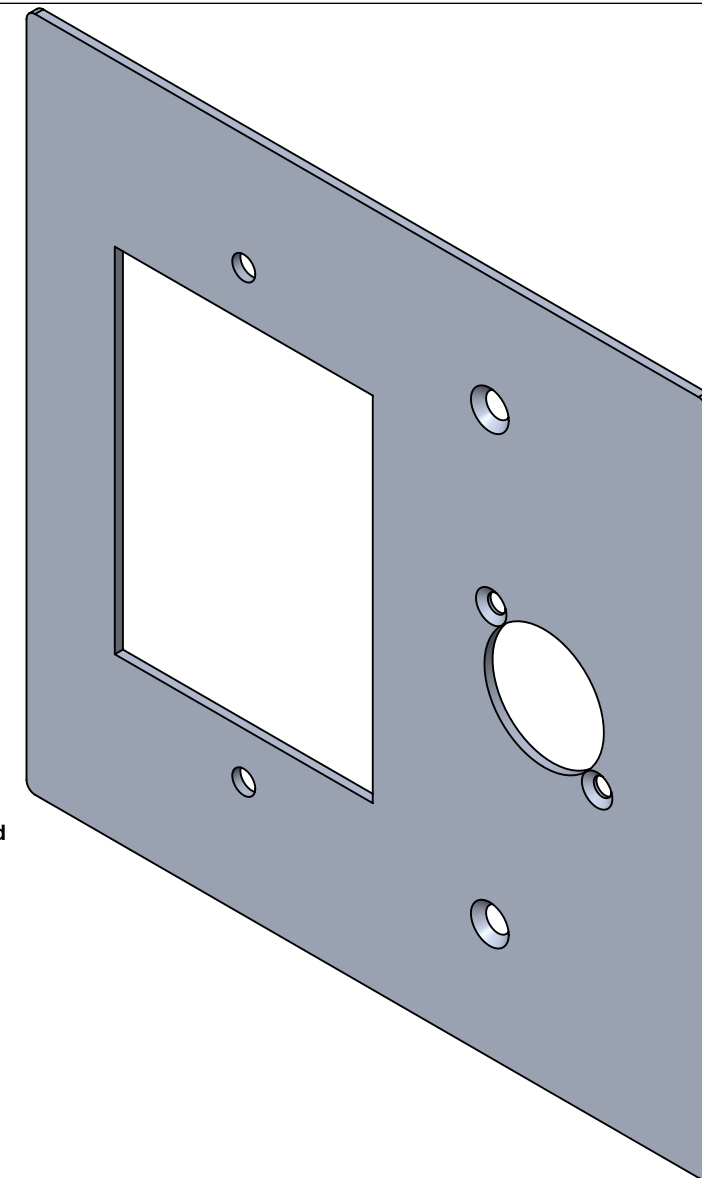

	DIMENSIONS ARE IN INCHES UNLESS OTHERWISE SPECIFIED TOLERANCES: FRACTIONAL 1/64" ANGULAR: BEND 01% THREE PLACE DECIMAL .005"	Drawn by:	Wentzel (Vince) Dippenaar
		Date:	1/24/20
		Rev:	19
		Page:	Sheet 1 of 1
		Scale:	1:1
Finish:	White or Black	THE INFORMATION CONTAINED IN THIS DRAWING IS THE SOLE PROPERTY OF JOHNSON SYSTEMS INC. ANY REPRODUCTION IN PART OR AS A WHOLE WITHOUT THE WRITTEN PERMISSION OF JOHNSON SYSTEMS INC. IS PROHIBITED.	
Note:	-		

**JOHNSON SYSTEMS INC.**

1923 Highfield Crescent SE.  
 Calgary, Alberta  
 Canada T2G 5M1  
 (403) 287-8003  
 (403) 287-9003 Fax



Project: PA-2A1-DMX

Note: -